

Transparent Frame and Diverse Boxes

-creating warm kid`s home-



Creating schools on any kind of site in Ukraine, because of the war people desire the warmest place where they can feel, here is comfortable, healed and at home. And the method how to create the schools need to be systematic, costless and flexible. For lack of manpower, especially skillful-workers. For that kind of reasons, we suggest very flexible systematic but diverse composition for the future schools in Ukraine, desiring Kids will be gathering there and fell home.

The frames composition could be transformed according to the site location under the one order which covering many kinds of diversity.

The outline of the complex is very simple. It accommodates a variety of sites and can be approached from anywhere. Multiple entrances can be set up for each grade, and students have multiple access to the facility.

One frame idea will be covering many kinds of diversity composed of functional boxes. Put the homogeneous, transparent frames according to the site. The standard spans of the frames are 10 m, but it would be modified according to each schools' conditions. Functional boxes would be infilled among the composition of frames. Basically, class rooms are infilled perimeter area facing to outside with random feeling of the connection of each function. The classroom boxes would surround the gymnasium and amphitheater, common big spaces. Because of these compositions, the central area will be the big common open space covered with Boxes and big roof with polycarbonated top light and solar cells. It will be cheerful winter garden fulfilled some actual greeneries and active kids. Organic feeling will be created. Functional boxes would be connected with calm sloops which enhance kid movement and the opportunity of encounter of kid, which develops new communication for each other. The shelters will be under ground at the bellow of the classes surrounding big spaces but covered with mounted soil. The composition will be the monastery's monks' rooms surrounding the open court. It creates a kind of community even if emergent situations. Under the gymnasium

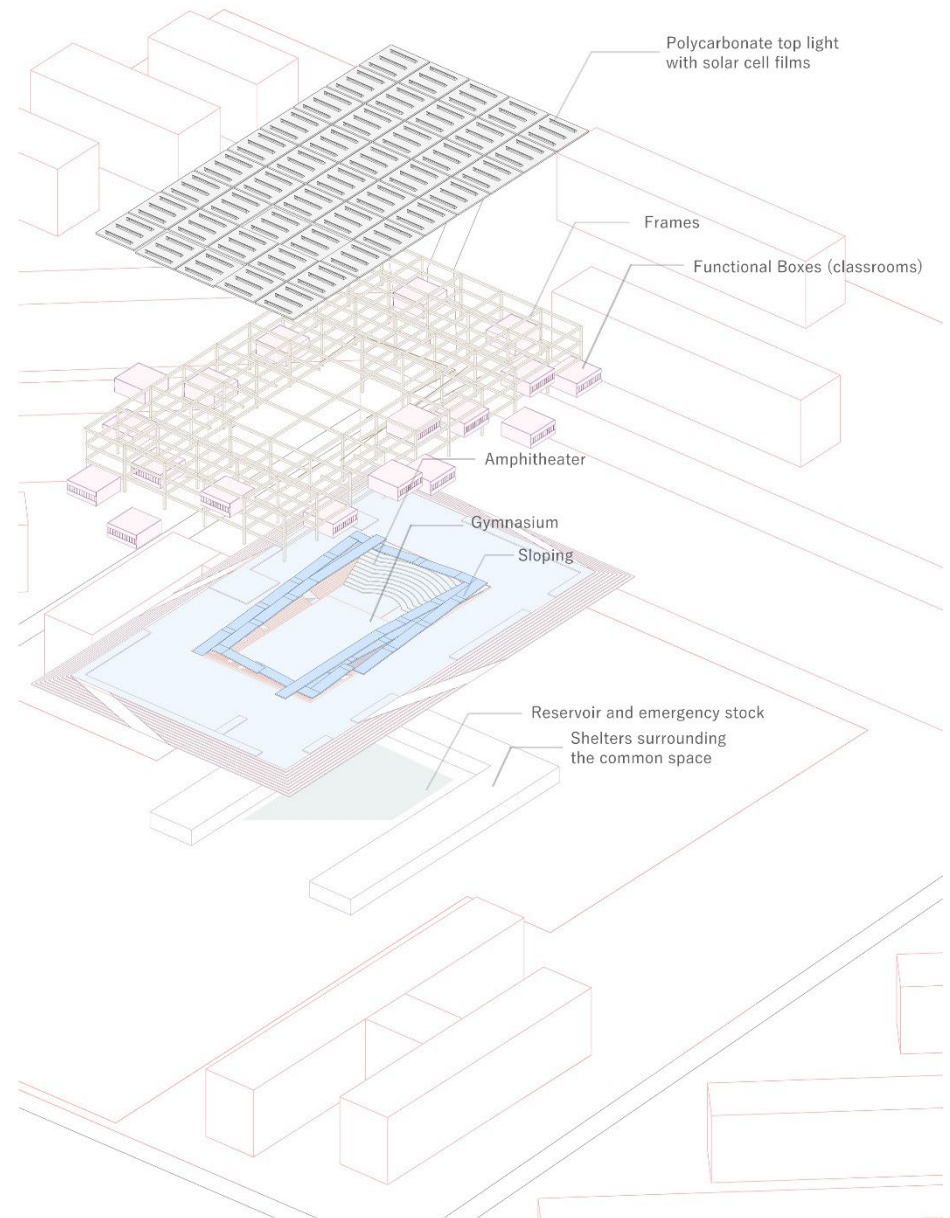

the pit will be act as reservoir and the storages for emergency. With the solar cells the facility can act as the stable evacuating space even if under emergency.

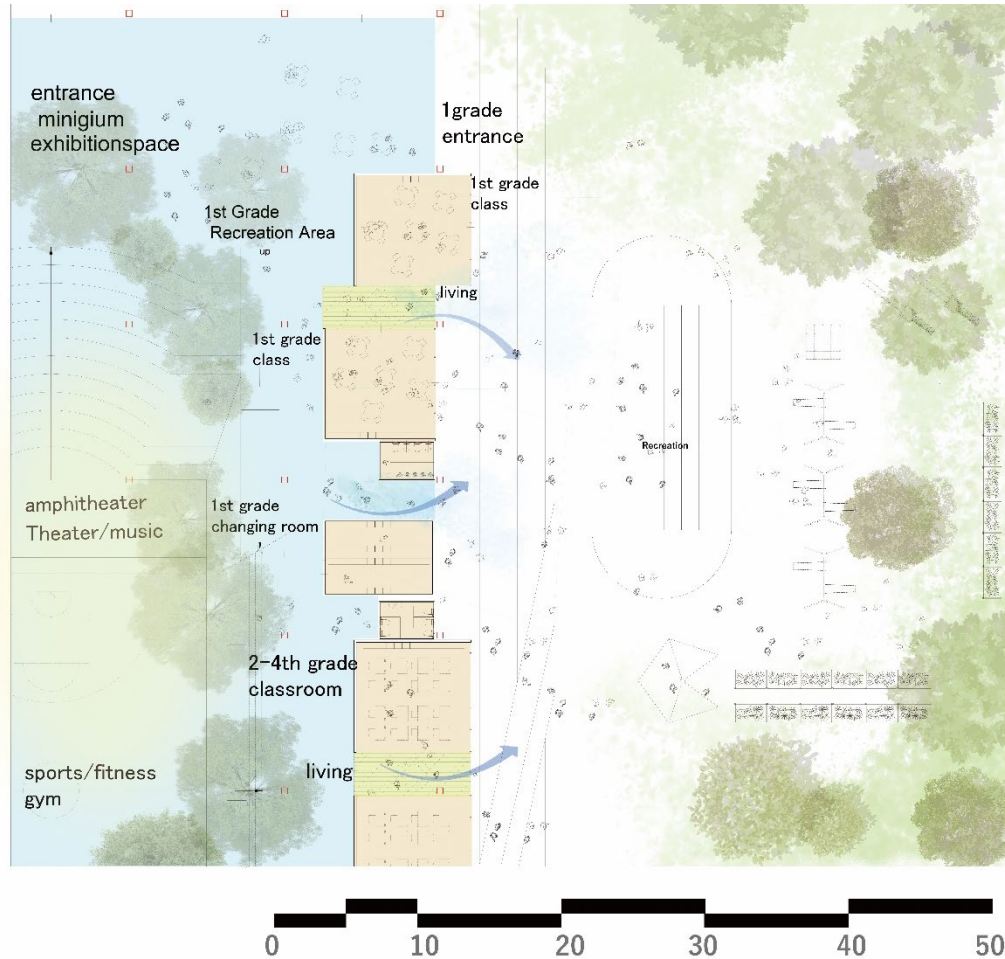

In case of site A, a diagonal axis runs toward the open space facing the road and connects it to the common space. “Boxes” (unit of classrooms) can be freely placed surrounding common area inside a simple frame that is similar to jungle gym. Although the order is homogeneous and simple, it will create freedom and liveliness for the users of the facility. The boxes and frame are independent of each other and are arranged with different elements. Living area is created by the gap formed by this arrangement, and acted as a buffer zone that gently connects each function. This area will be used for students to relax like a second home. This living area allows for a variety of uses. It can also be used as a single room for classes, or a study spaces for students. It also can be directly accessed from the outside. When the classroom walls are fully opened, it can transform into a bigger space for multipurpose area with an integrated interior and exterior.

Adaptable classroom and flexible space feels like a second living

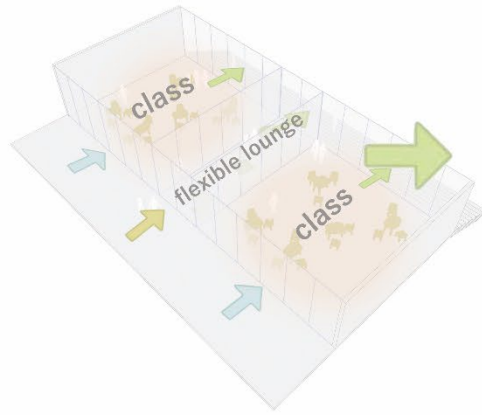

The unit box and frame are independent of each other and arranged with different elements. Living is created in the difference (gap) created by this operation, and is used as a buffer zone that gently connects classrooms and functions.

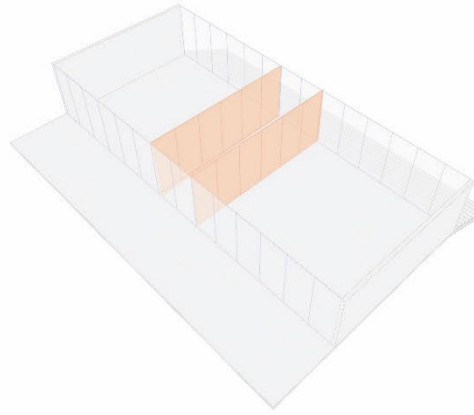

The living room will be used as a place for students to relax. It is like a second home, and we aim to create a space that is not as functional as a classroom, nor as public as a common space, but has a softness to it.



Living allows for a variety of uses. It can be used to transform a classroom into a connected hall, a study space for students, or for recreation, as a drinking fountain that seamlessly connects to the schoolyard.

Common aisle of each function within the complex is not only used as hallway, but also can be used as a study space, library space, and dining space for students. We aim to create a space that not only functioned as a classroom nor as a common space, but also have gentle touch that can soothe the user of the facility.

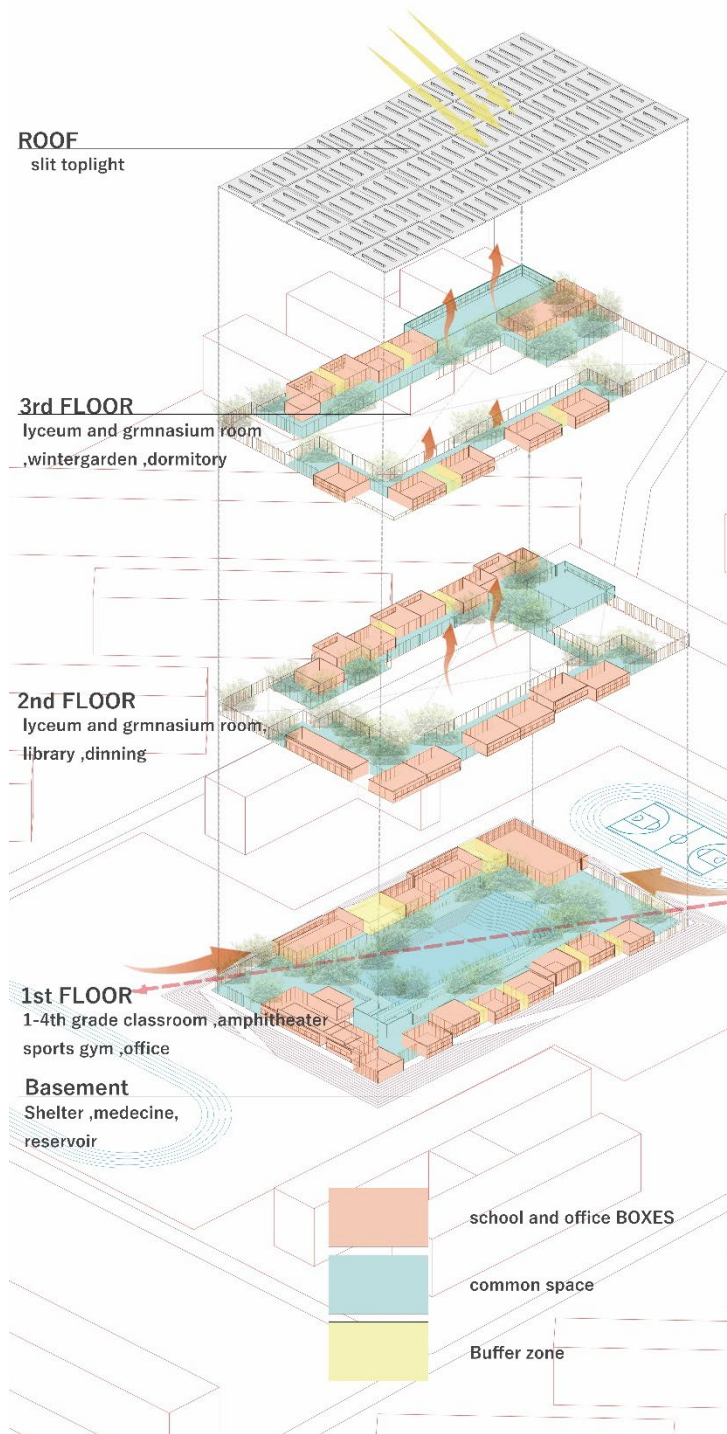

A ramp will be placed around the central common space (amphitheater and sports gym) where students can enjoy a variety of activities and events together. The ramps connect the 1st floor up to 3rd floor. A large void also designed to bring energy to the common area and to naturally draw in warm air.

